

零件目录

PARTS CATALOGUE



KINROAD

Kinroad xintian Motorcycle Manufacture co., ltd

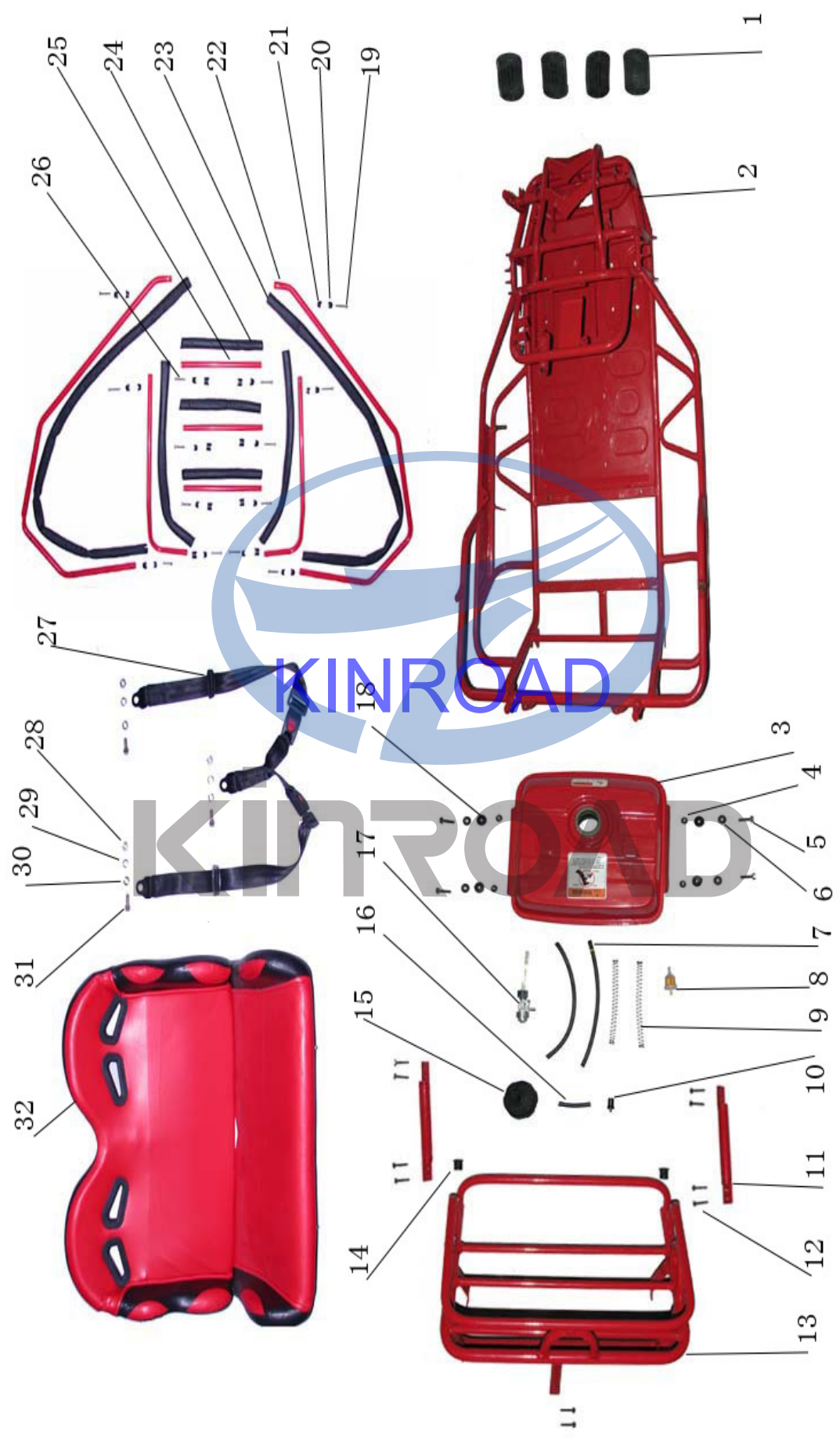

NO.	Part NO.	Description	Description in English	数量Qty	价格Price	备注Remark
1	KC003320000	脚踏橡胶板	FOOT PLATE.RUBBER	4		
2	KC001010000-1	主车架	FRAME COMP.	1		
3	KC002020000-1	油箱	TANK, COMP. FUEL	1		
4	GB6187-86	六角法兰自锁螺母 M6	LOCK NUT FLANGE M6	4		
5	GB5787-86	六角法兰螺栓M6×16	BOLT M6×16	4		
6	GB/T96.1-2002	垫片6	WASHER 6	4		
7	KE003210100-1	油管	TUBE COMP.FUEL	2		
8	KA002090000	过滤器	FILTER	1		
9	KA001830050	油管保护网	FUEL TUBE SPRING	2		
10	KA002070000	止回阀	CHECK VALVE	1		
11	KE101140000	后储物架支架	SUPPORTER, CARRIER	2		
12	GB5787-86	六角法兰螺栓M6×25	BOLT M6×25	10		
13	KC101350000-1	后货架	CARRIER COMP., REAR	1		
14	KC003140020	后货架橡胶盖	RUBBER COVER, CARRIER COMP.	2		
15	KA002060100	油箱盖	CAP, COMP. FUEL TANK	1		
16	KE003210100-1	油管	TUBE COMP.FUEL	1		
17	KE002080000	油箱开关	COCK, FUEL ASSY.	1		
18	KC003140010	m6橡皮垫	RUBBER WASHER 6	4		
19	GB/T 70.1-2000	内六角螺栓M8×40	BOLT M8×40	6		
20	KC003140000	防护杆螺栓盖 (B)	BRUSH GUARD BAR ,BOLT COVER(B)	14		
21	KC003130000	防护杆螺栓盖 (A)	BRUSH GUARD BAR ,BOLT COVER(A)	6		

22	KC001150010	保险杠架	RIGHT BRUSH GUARD BAR ,MAIN	2		
23	KC001150011	保险杠架保护套	FOAM COVER	2		
24	KC001150012	保险杠横杆保护套	FOAM COVER	3		
25	KC101070000	保险杠横杆	BRUSH GUARD BAR ,CENTER	3		
26	GB/T 70.1-2000	内六角螺栓M8×50	BOLT M8×50	8		
27	KC007020000-1	安全带	BELT.SAFETY	1		
28	GB/T41-2000	安全带安装螺母	NUT, SAFETY BELT	3		
29	GB/T93-87	安全带安装弹垫	SPRING WASHER, SAFETY BELT	3		
30	GB/T96.1-2002	安全带安装平垫	WASHER, SAFETY BELT	3		
31	GB5787-86	安全带安装螺栓	SPECIAL BOLT, SAFETY BELT	3		
32	KC007010000-1	座垫	SEAT ASSY.	1		

KINROAD

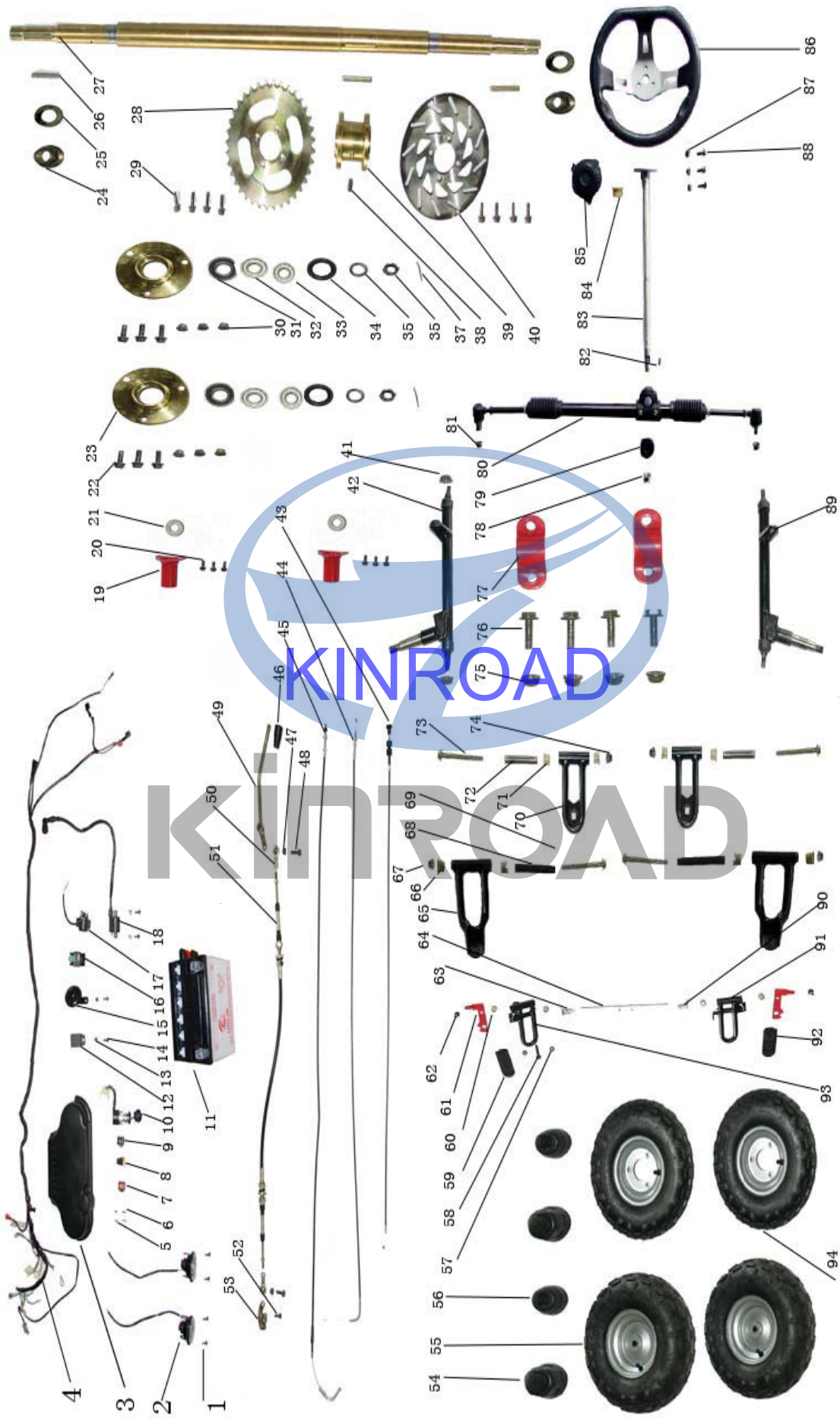

- 1
- 2
- 3
- 4
- 5
- 6
- 7
- 8
- 9
- 10
- 11
- 12
- 13
- 14
- 15
- 16
- 17
- 18
- 19
- 20
- 21
- 22
- 23
- 24
- 25
- 26
- 27
- 28
- 29
- 30
- 31
- 32
- 33
- 34
- 35
- 37
- 38
- 39
- 40
- 41
- 42
- 43
- 44
- 45
- 46
- 47
- 48
- 49
- 50
- 51
- 52
- 53
- 54
- 55
- 56
- 57
- 58
- 59
- 60
- 61
- 62
- 63
- 64
- 65
- 66
- 67
- 68
- 69
- 70
- 71
- 72
- 73
- 74
- 75
- 76
- 77
- 78
- 79
- 80
- 81
- 82
- 83
- 84
- 85
- 86
- 87
- 88
- 89
- 90
- 91
- 92
- 93
- 94

NO.	Part NO.	Description	Description in English	数量Qty	价格Price	备注Remark
1	GB5787-86	六角法兰螺栓M6×12	BOLT FLANGE M6×12	4		
2	KC004020000	大灯组件	HEAD LAMP ASSY.	2		
3	KC003150000	前面罩	COVER.SWITCH	1		
4	KC004120000-1	主电缆	MAIN WIRE HARNESS	1		
5	GB845-85	自攻螺钉ST3.9×10	screw, ST3.9×10	2		
6	GB845-85	自攻螺钉ST3.9×7	screw, ST3.9×7	2		
7	KA004020000	熄火开关	SWITCH COMP., IGNITION STOP	1		
8	KC004010000	喇叭开关	SWITCH COMP., HORN	1		
9	KA004030000	照明开关	SWITCH COMP., HEAD LIGHT	1		
10	KA004010000	点火锁	KEY SET-IGNITION SWITCH COM	1		
11	KA003360000	蓄电池	BATTERY	1		
12	KA004040000	调压整流器	RECTIFIER COMP, REGULATE	1		
13	GB6187-86	六角法兰自锁螺母 M6	LOCK NUT FLANGE M6	3		
14	GB5787-86	六角法兰螺栓M6×16	BOLT M6×16	3		
15	KC004060000	喇叭	HORN	1		
16	KC004080000-1	CDI点火器	CDI UNIT	1		
17	KA004050000	起动继电器	STARTING RELAY	1		
18	KC004090000-1	高压包	COIL COMP. IGNITION	1		
19	KC101330000	后轮轴承座	HOUSING COMP, RR.AXLE BRG	2		
20	GB5787-86	六角法兰螺栓M8×16	BOLT FLANGE M8×16	6		
21	KA005510000	轴承6204 2RZ	BEARING 6204 2RZ	2		
22	GB5787-86	六角法兰螺栓M8×25	BOLT FLANGE M8×25	6		
23	KE005040030	前轮毂	HUB, FR. WHEEL	2		

24	GB6187-86	六角法兰自锁螺母 M16	LOCK NUT FLANGE M16	2		
25	GB/T95-85	平垫 ϕ 16	WASHER ϕ 16	2		
26	KA005060030	平键销	FLAT KEY	3		
27	KA005040030-1	后轮轴	AXLE COMP., RR.	1		
28	KA005210030-1	链轮36齿	REAR SPROCKET	1		
29	GB5787-86	六角法兰螺栓M6 \times 16	BOLT M6 \times 16	8		
30	GB6187-86	六角法兰自锁螺母 M8	LOCK NUT FLANGE M8	6		
31	KE005520010	前轮毂油封1	DUST SEAL1, FR. HUB	2		
32	KE005520000	轴承6204RZ	AXLETREE 6204RZ	2		
33	KE005520000	轴承6204RZ	AXLETREE 6204RZ	2		
34	KE005520020	前轮毂油封2	DUST SEAL2, FR. HUB	2		
35	KA005060030	衬套	BUSH,	2		
36	GB6178-86	六角开槽螺母 M14 \times 1.5	NUT, RR. AXLE M14 \times 1.5	2		
37	GB/T91-86	开口销 Φ 3.2 \times 32	PIN Φ 3.2 \times 32	2		
38	GB/T78-2000	内六角锥端紧固螺钉M8 \times 16	BOLT M8 \times 16	1		
39	KA005050030	后轮轴轴套	SHAFT BUSH	1		
40	KA005310200	后碟刹盘组件	DISC, RR. BRAKE	1		
41	GB6187-86	六角法兰自锁螺母 (M10)	LOCK NUT FLANGE (M10)	4		
42	KC00604001A	右支撑轴	KNUCKLE SUPPORT, RH	1		
43	KC006231000	风门线	CHOKE CABLE	1		
44	KC006210000	油门线	CABLE COMP.THROTTLE	1		
45	KC006220000	刹车线	CABLE COMP. BRAKE	1		
46	KA003380000	倒档器手柄套	cover, lever.	1		
47	GB6187-86	六角法兰自锁螺母 M8	LOCK NUT FLANGE M8	1		
48	GB5787-86	六角法兰螺栓M8 \times 25	BOLT FLANGE M8 \times 25	1		

49	KC101370000	倒档手柄	SHIFT GEAR THE POLE	1		
50	KC006020100	球头	ROD END	2		
51	KC006230000-1	倒档线	CABLE COMP.REVERSE	1		
52	GB5787-86	六角法兰螺栓M6×20	BOLT M6×20	1		
53	KE001830000	换挡摇臂	GEARSHIFT BRAKET	1		
54	KC003360000	后轮轴盖	CAP, RR. WHEEL	2		
55	KA005020200-1	后辐板轮	RIM, REAR	2		
56	KC003360000	前轮轴盖	CAP, FR. WHEEL	2		
57	KC006020400	调节螺母M8	NUT ,HEX M8	2		
58	GB5787-86	六角法兰螺栓M8×40	BOLT FLANGE M8×40	1		
59	KC003330000	油门橡胶块	RUBBER, THROTTLE	1		
60	KC103610000	尼龙衬套	COLLAR, FOR PEDAL COMP., BI	4		
61	KC101310000	拉线固定支架	BRACKET FOR CABLE	2		
62	GB5787-86	六角法兰螺栓M8×16	BOLT FLANGE M8×16	3		
63	KC001820030	油门踏板扭簧	SPRING, THROTTLE PEDAL	1		
64	KC101930040	油门、刹车踏板轴	SHAFT FOR THROTTLE PEDAL	1		
65	KC10118001A	下悬挂	SUSPENSION ARM COMP, LOWE	2		
66	KC103610000	悬挂尼龙衬套	BUSH, SUSPENSION ARM ASSY.,	4		
67	GB6187-86	六角法兰自锁螺母 (M8)	LOCK NUT FLANGE (M8)	2		
68	KC101920000	下悬挂中心衬管	SPACER, CENTER LOWER	2		
69	GB5787-86	六角法兰螺栓M8×105	BOLT FLANGE M8×105	2		
70	KC10117001A	上悬挂	SUSPENSION ARM COMP, UPPER	2		
71	KC103610000	悬挂尼龙衬套	BUSH, SUSPENSION ARM ASSY.,	4		
72	KC101910000	上悬挂中心衬管	SPACER, CENTER UPPER	2		
73	GB5787-86	六角法兰螺栓M8×100	BOLT FLANGE M8×100	2		

74	GB6187-86	六角法兰自锁螺母 (M8)	LOCK NUT FLANGE (M8)	2		
75	GB6187-86	六角法兰自锁螺母 M6	LOCK NUT FLANGE M6	4		
76	GB5787-86	六角法兰螺栓M6×25	BOLT M6×25	4		
77	KC00153001A	方向器压板	STEERING GEAR BRACKET	2		
78	GB6187-86	六角法兰自锁螺母M10	LOCK NUT FLANGE (M10)	1		
79	KC006010300	齿轮	GEAR	1		
80	KC006010100	方向器总成	STEERING GEAR	1		
81	GB6187-86	六角法兰自锁螺母 (M8)	LOCK NUT FLANGE (M8)	2		
82	KC101320100	平键	FLAT KEY	1		
83	KC101320000	边向轴	STEERING SHAFT	1		
84	KC103610000	尼龙衬套	COLLAR, FIXING STEERING SHAFT	1		
85	KC003020000	边向器螺栓盖	COVER, STEERING BOLT	1		
86	KC006050000	方向盘	STEERING COMP.	1		
87	GB6187-86	六角法兰自锁螺母 (M6)	LOCK NUT FLANGE (M6)	3		
88	GB5787-86	六角法兰螺栓M6×16	BOLT FLANGE M6×16	3		
89	KC00603001A	左支撑轴	KNUCKLE SUPPORT, LH	1		
90	KC001810030	刹车踏板扭簧	SPRING, BRAKE PEDAL	1		
91	KC10116001A	刹车踏板组件	PEDAL COMP., BRAKE	1		
92	KC003340000	刹车橡胶块	RUBBER, BRAKE	1		
93	KC10115001A	油门踏板组件	PEDAL COMP., THROTTLE	1		
94	KA005010200-1	前辐板轮	RIM, FR.	2		

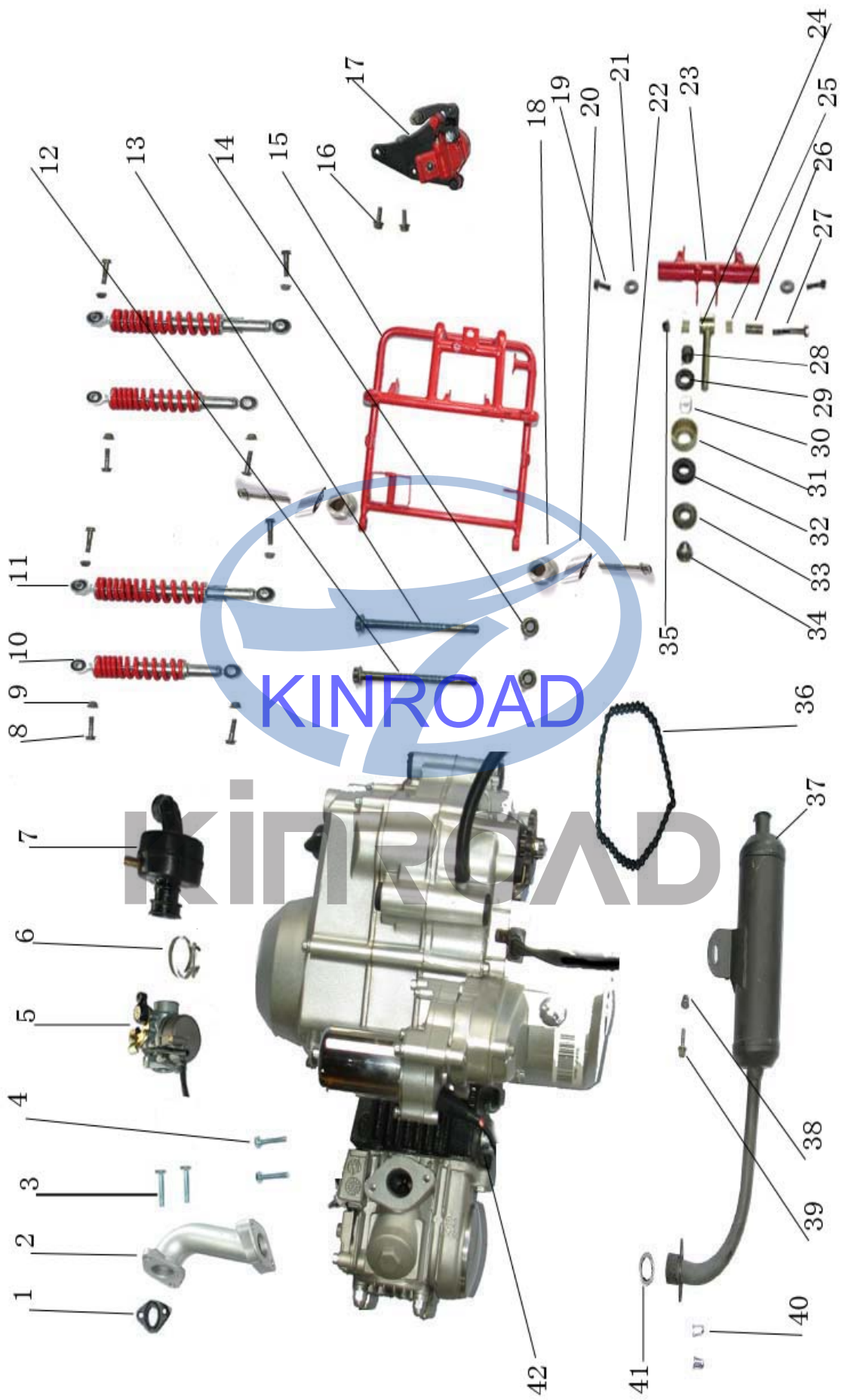

NO.	Part NO.	Description	Description in English	数量Qty	价格Price	备注Remark
1	50Z 12020	进气管胶垫	GASKET,INTAKE PIPE	1		
2	KE002050000	进气管	INTAKE PIPE	1		
3	GB5787-86	六角法兰螺栓M6×30	BOLT M6×30	2		
4	GB5787-86	六角法兰螺栓M6×25	BOLT M6×25	2		
5	KC002020000-1	化油器	CARBURETOR ASSY	1		
6	KE0A2040000	卡箍	CLAMP	1		
7	KC0A2030000	空滤器	AIR CLEANR ASSY.	1		
8	GB5787-86	六角法兰螺栓M8×40	BOLT M8×40	8		
9	GB6187-86	六角法兰自锁螺母 (M8)	LOCK NUT FLANGE (M8)	8		
10	KC00631001B-1	前减震器	ABSORBER ASSY. FR.	2		
11	KE006320010	后减震器	ABSORBER ASSY. RR.	2		
12	GB5787-86	六角法兰螺栓M8×115	BOLT M8×115	1		
13	GB5787-86	六角法兰螺栓M8×105	BOLT M8×105	1		
14	GB6187-86	六角法兰自锁螺母 (M8)	LOCK NUT FLANGE (M8)	2		
15	KC00120001A-2	后摇架	REAR SWING ARM COMP.	1		
16	GB70-86	内六角螺栓M6×16	BOLT M6×16	2		
17	KE100531000-2	制动泵	CALIPER HYDRAULICAL BRAKE, R	1		
18	GB6187-86	六角法兰自锁螺母 (M10)	LOCK NUT FLANGE (M10)	2		
19	GB5787-86	六角法兰螺栓M8×20	BOLT FLANGE M8×20	2		
20	KC003390000	减震套	RUBBER BUSH, SWING ARM	2		
21	GB/T97-85	平垫 (ø8)	FLAT WASHER (ø8)	2		
22	GB5787-86	六角法兰螺栓M10×40	BOLT M10×55	2		
23	KE001330000	发动机连接器	BRACKET, ENGINE FIXING	1		

24	KE001320030	吊杆	LINK COMP, ENGINE MOUNT	1		
25	KC103610000	尼龙衬套	COLLAR, ENGINE MOUNTING LINK	2		
26	KC101910000	中心衬管	SPACER, CENTER	1		
27	GB5787-86	六角法兰螺栓M8×40	BOLT M8×40	1		
28	90293-BCA0-0000-0C	调整螺母 M12×1.25	NUT, ENGINE MOUNT LINK M12×1.25	1		
29	52155-BCA0-0000	缓冲器垫圈	WASHER, BUFFER PAD	1		
30	52152-BCA0-0000-0C	隔震环	COLLAR, ENGINE MOUNT LINK	1		
31	KA001550030	缓冲器座	SPACER, ENGINE MOUNT LINK	1		
32	KA003390000	吊架缓冲橡胶圈	BUFFER PAD, ENGINE MOUNT LINK	1		
33	KA001550030	缓冲器座	SPACER, ENGINE MOUNT LINK	1		
34	GB6187-86	六角法兰自锁螺母 (M12×1.25)	LOCK NUT FLANGE M12 ×1.25	1		
35	GB6187-86	六角法兰自锁螺母 (M8)	LOCK NUT FLANGE (M8)	1		
36	KA005230000	链条428 48节	CHAIN 428	1		
37	KE0A2040000	排气消声器总成	MUFFLER COMP.,EX	1		
38	GB6187-86	六角法兰自锁螺母 (M8)	LOCK NUT FLANGE (M8)	1		
39	GB5787-86	六角法兰螺栓M8×20	BOLT FLANGE M8×20	1		
40	KE002300000	盖形长螺母M6×25	NUT, MUFFLER JOINT M6×35	2		
41	KE0A2040001	排气管密封垫	GASKET, EX. PIPE	1		
42	KE002010000	发动机	ENGINE ASSY	1		