

XT250GK-7卡丁车图解目录 (赛手款非EEC左方向)

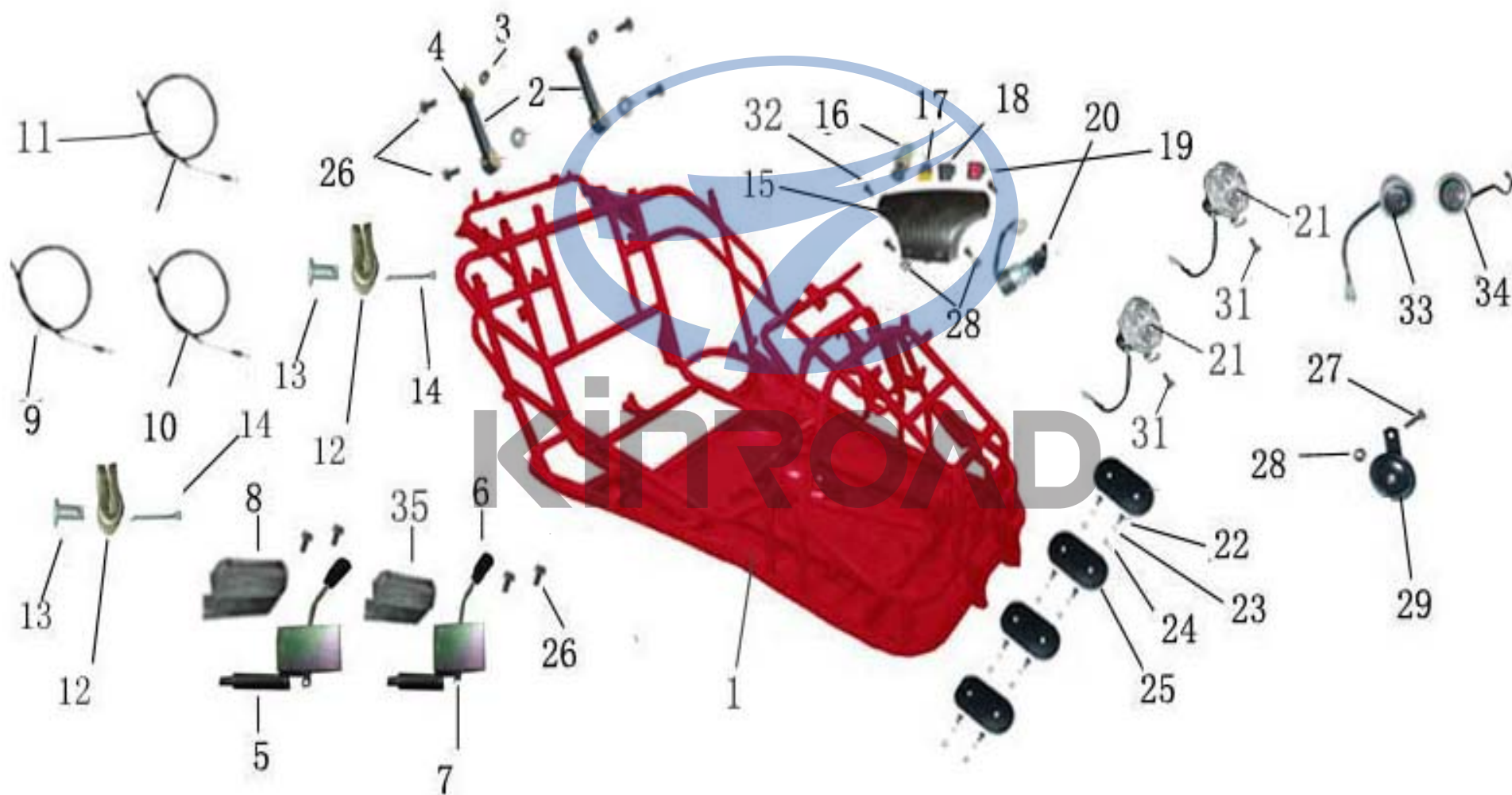

NO.	Part NO.	Description	Description in English	數量Qty	價格Price	備註Remark
1	KB101010000-2E	车架组件	FRAME COMP.	1		
2	KA00172001A	连杆	CONNECTING ROD	2		
3	KA00172001A-1	连杆垫	WASHER, CONNEECTING ROD	4		
4	KA00172001A-2	连杆衬套	BUSH, CONNECTING ROD	8		
5	KB001160000	倒档器手柄	HANDLE BAR, REVERSE	1		
6	KA003380000	手柄套	COVER LEVER	2		
7	KB2S1170000	手刹制动柄	HANDLE BAR, BRAKE	1		
8	KA003400000	倒档器手柄护套	COVER REVERSE LEVER	1		
9	KB106220000-1	油门线	CABLE COMP. THROTTLE	1		
10	KB106210000-1	手刹线	CABLE COMP. PARKING BRAKE	1		
11	KA106230000-1	倒档线	CABLE COMP. REMERSE	1		
12	KA106220100-1	支架	BRACKET	2		
13	GB/T882-86	B型销轴	PIN	2		
14	GB/T91-86	开口销 1.6×16	PIN 1.6×16	2		
15	KA003080000-1	面板	COVER. SWITCH	1		
16	KA004190000	点烟器	CIGAR LIGHTER	1		
17	KC004010000	喇叭开关	HORN BUTTON	1		
18	KA004030000	照明开关	TOPLIGHT SWITCH	1		
19	KA004020000	熄火开关	ENGINE STOP BUTTON	1		
20	KA004010000	点火锁	KEY SET-IGNITION SWITCH COMP.	1		
21	KA004100000-2	大灯组件	HEAD LAMP ASSY.	2		
22	KA003330000	脚踏橡胶板	FOOT PLATE. RUBBER	4		
23	KA003330100	脚踏橡胶板螺钉	BOLT, FOOT PLATE. RUBBER	8		
24	KA003330200	脚踏橡胶板垫片	WASHER, FOOT PLATE. RUBBER	8		
25	KA003330300	脚踏橡胶板螺母	NUT, FOOT PLATE. RUBBER	8		
26	GB5787-86	六角法兰螺栓 M8×16	BOLT, FLANGE M8×16	8		
27	GB5787-86	六角法兰螺栓M6×16	BOLT, FLANGE M6×16	2		
28	GB6187-86	六角法兰自锁螺母M6	NUT FLANGE M6	3		
29	KA204180000	喇叭	HORN	4		

30	GB6187-86	六角法兰自锁螺母M6	NUT FLANGE M6	3		
31	GB5787-86	六角法兰螺栓M5×12	BOLT, FLANGE M5×12	2		
32	GB/T818-85	十字盘头螺钉M6×16	BOLT, M6×16	4		
33	KA0A4150000	转速表	SPEEDOMETER	1		
34	KB004180000	水温表	WATER TEMPERATURE METER	1		
35	KA003500000	手刹制动柄护套	COVER HANDLE BAR, BRAKE	1		



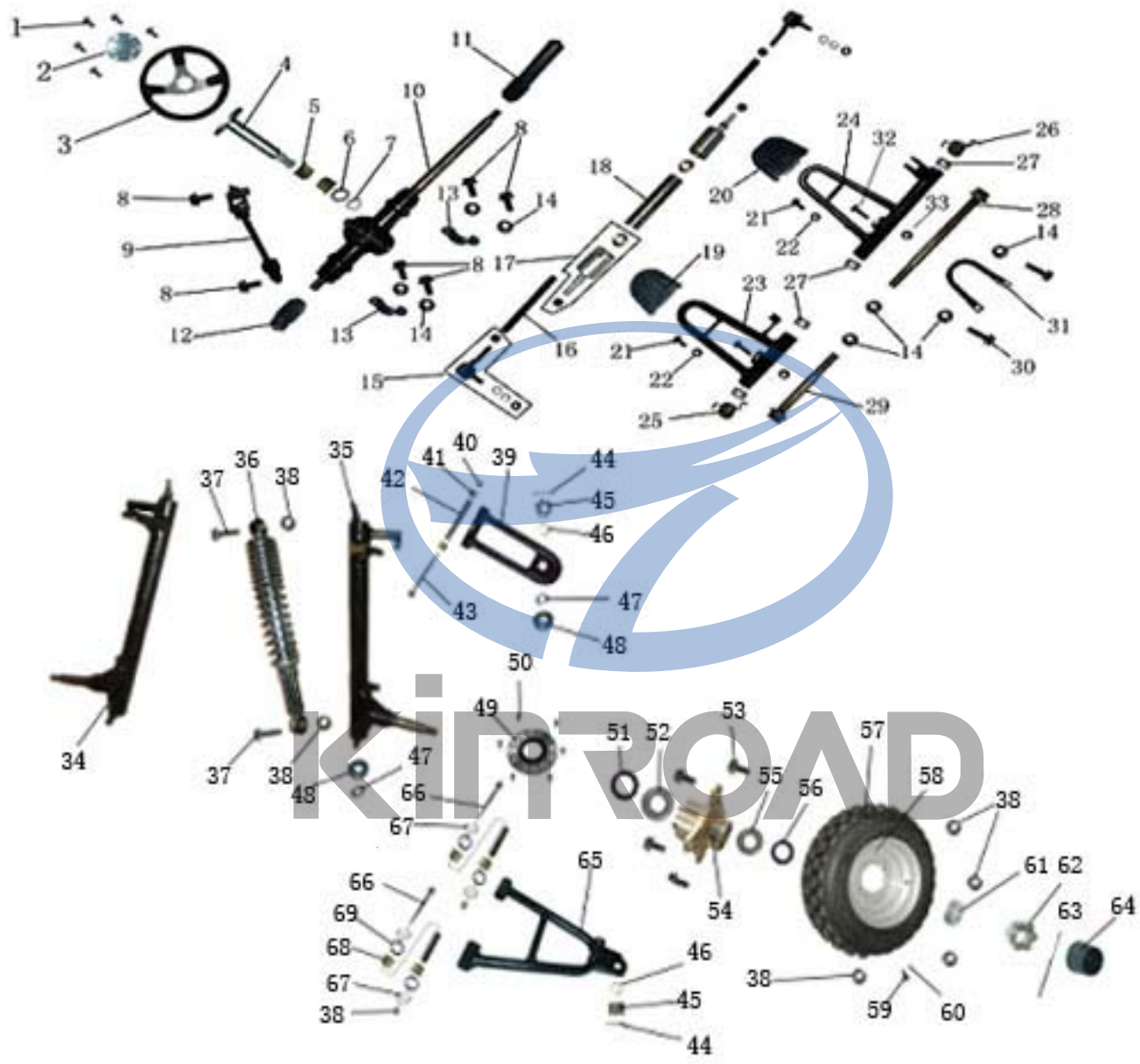

NO.	Part NO.	Description	Description in English	數量Qty	價格Price	備註Remark
1	GB5787-86	六角法兰螺栓M6×12	BOLT, FLANGE M6×12	6		
2	KB003020000	变向器螺栓盖	COVER STEERING COMP.	1		
3	KB003310000	方向盘	STEERING COMP.	1		
4	KA10171001A	边向轴	STEERING SHAFT	1		
5	KA101021000	方向柱尼龙衬套	BUSH. STEERING SHAFT	2		
6	GB/T95-85	平垫Φ20	WASHER ø20	1		
7	GB/T894-86	轴用弹性挡圈	CIRCLIP ø20	1		
8	GB5787-86	六角法兰螺栓M8×25	BOLT, FLANGE M8×25	6		
9	KA006010400-2	转向关节轴	SEEERING KNUCKLE	1		
10	KA10601011A	变向箱	STEERING GEAR	1		
11	KA006010300	防尘盖	DUST COVER. R. BALL JOINT	1		
12	KA106010300	防尘盖I	DUST COVER. L BALL JOINT	1		
13	KA00153001A	变向器固定板	STEERING GEAR BRACKET	2		
14	GB6187-86	六角法兰自锁螺母M8	NUT FLANGE M8	8		
15	KA10601111A	连接杆球头	ROD END	2		
16	KA10601051A-1	左、右连接杆	TIE ROD	2		
17	KA006010240	万向节	STEERING BALL JOINT	2		
18	KA10601121A	限位套筒	SLEEVE	2		
19	KA003320000	油门脚踏橡胶套	PUSH ROD, MASTER	1		
20	KA003320000-1	刹车脚踏橡胶套	RUBBER, PAD	1		
21	GB5787-86	六角法兰螺栓M5×16	BOLT, FLANGE M5×16	4		
22	GB6187-86	六角法兰自锁螺母M5	NUT FLANGE M5	4		
23	KA00115001A	节气门踏板组件	PEDAL COMP., THROTTLE	1		
24	KA00116001A	刹车踏板组件	PEDAL COMP., BRAKE	1		
25	KA001820030	节气门踏杆扭簧	SPRING, THROTTLE PEDAL	1		
26	KA001810030	刹车踏杆扭簧	SPRING, BRAKE PEDAL	1		
27	KA101024000	踏板减震环	COLLAR, PEDAL	4		
28	53391-BCA0-0000-0C	刹车踏杆螺栓 M8×221	BOLT M8×221	1		
29	53393-BCA0-0000-0C	节气门螺栓 M8×145	BOLT M8×145	1		
30	GB5787-86	六角法兰螺栓 M8×35	BOLT, FLANGE M8×35	2		
31	KA101350000	刹车泵保护支架	BRACKET, CYLINDER ASSY,	1		
32	GB5787-86	六角法兰螺栓 M8×40	BOLT, FLANGE M8×40	2		
33	GB6170-86	六角螺母M8	NUTM8	2		
34	KA00603001A	右支撑轴	KNUCKLE SUPPORT, RH	1		

35	KA00602001A	左支撑轴	KNUCKLE SUPPORT, LH	1		
36	KB00631001B	前减震器	ABSORBER ASSY. FR.	2		
37	GB5787-86	六角法兰螺栓 M10×40×1.25	BOLT FLANGE M10×40×1.25	4		
38	GB6187-86	六角法兰自锁螺母 (M10×1.25)	LOCK NUT FLANGE M10×1.25	16		
39	KA10117001A-1	上悬挂臂组件	SUSPENSION ARM COMP, UPPER	2		
40	GB6187-86	六角法兰自锁螺母 M8	LOCK NUT FLANGE M8	2		
41	KA101023000	上摆臂尼龙衬套	BUSH, ARM ASSY., UPPER	4		
42	KA101010300	前上摆臂套筒内心管	SPACER, CENTER	2		
43	GB5787-86	上悬挂臂安装螺栓 M8×105	BOLT M8×105	2		
44	GB/T91-86	开口销1.6×30	PIN 1.6×30	4		
45	GB6178-86	六角开槽螺母M12×1.25	NUT M12×1.25	4		
46	GB/T93-87	弹垫12	SPRING WASHER 12	4		
47	KA001590030	隔环	SPACER, BALL HEAD	4		
48	KA003340000	转向轴防尘罩	RUBBER DUST COVER	4		
49	KA105310100-2	刹车碟	DISC, FR. BRAKE	2		
50	GB5783-2000	六角头螺栓M6×12	BOLT M6×12	12		
51	KA005440000	油封 47×25-7	DUST SEAL 47×25-7	2		
52	KA005520000	轴承 6204	BEARING 6204	2		
53	GB5787-86	辐板轮安装螺栓 M10	BOLT, TIRE M10	8		
54	KA005040030	前轮毂	HUB, FR. WHEEL	2		
55	96100-62030	轴承 6203	BEARING 6203	2		
56	91202-BCA0-0000	油封 42×27-7.3	DUST SEAL 42×27-7.3	2		
57	44710-BCA0-0000	真空胎21"×7"-10"	TIRE, FR. 21"×7"-10"	2		
58	KA005010000	前辐板轮	RIM, FR.	2		
59	KA005030100	气门嘴	INTAKE, TIRE	2		
60	KA005030200	气门嘴帽	CAP, TIRE INTAKE	2		
61	KB001650087	前轮衬套	SPACER, FR. HUB	2		
62	GB6178-86	六角开槽螺母M14×1.5	NUT M14×1.5	2		
63	GB/T91-86	开口销2.5×30	PIN 2.5×30	2		
64	KA003350000	后轮轴盖	CAP, FR. WHEEL	2		
65	KA10118001A	下悬挂臂总成	SUSPENSION ARM COMP, LOWER	2		
66	GB5787-86	下悬挂臂安装螺栓 M10×80	BOLT M10×80	4		
67	KA101022000	下摆臂尼龙衬套	BUSH, SUSPENSION ARM LOWER	8		
68	KA001670030	下悬挂臂防尘盖	DUST CAP, SUSPENSION LOWER	8		
69	KA003410000	O型圈 Φ20×Φ2.5	RUBBER RING Φ20×Φ2.5	8		

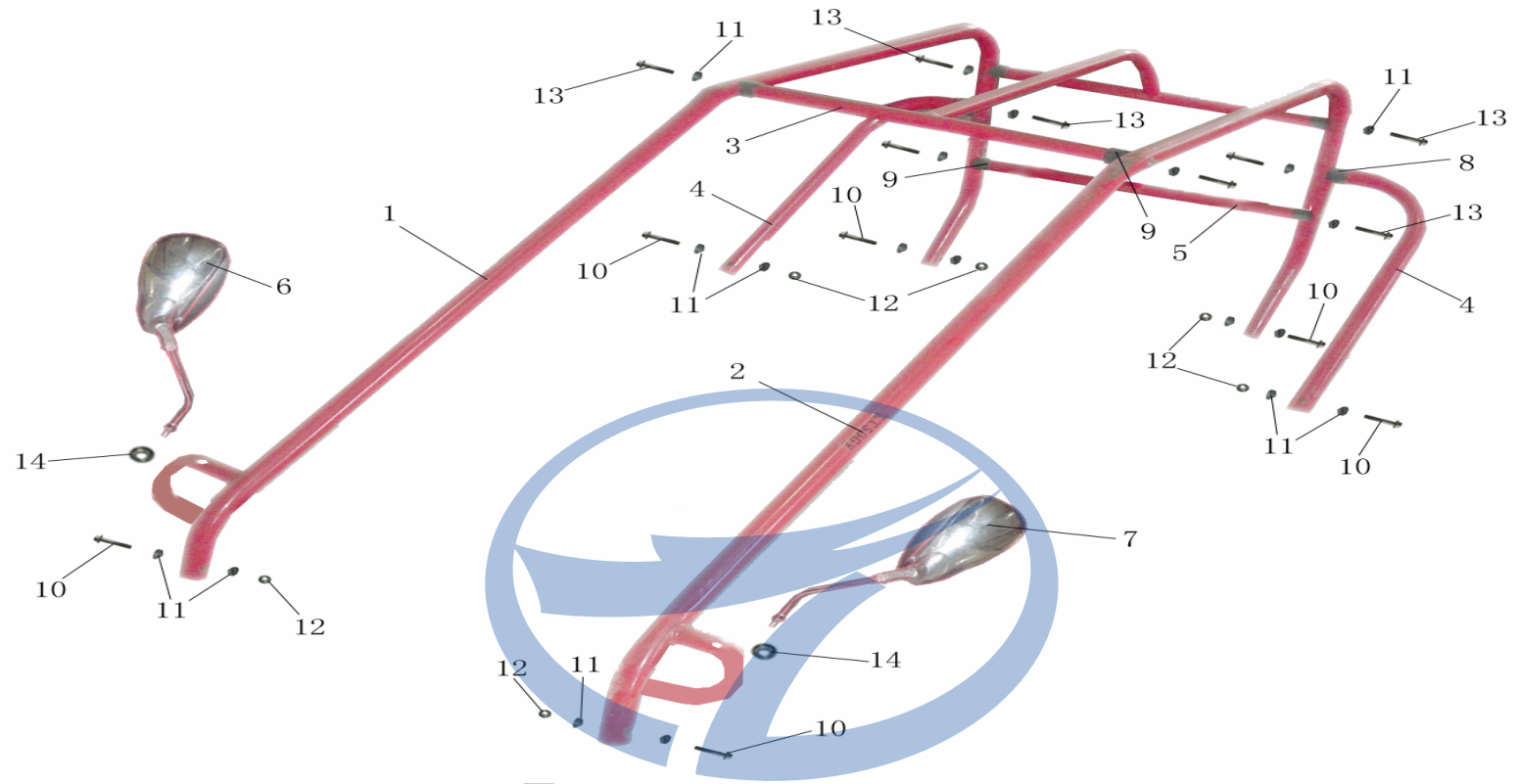

KINROAD

NO.	Part NO.	Description	Description in English	數量Qty	价格Price	备注Remark
1	KA101020000	右保险杠架	RIGHT BRUSH GUARD BAR ,MAIN	1		
2	KA101020100	左保险杠架	LEFT BRUSH GUARD BAR ,MAIN	1		
3	KA101080000	前护杆	LEFT BRUSH GUARD BAR ,MAIN	1		
4	KA101110000	保护杆	BRUSH GUARD BAR ,RR	2		
5	KA101070000	保险杠横杆	BRUSH GUARD BAR ,CENTER	1		
6	KA204250200	右后视镜	RIGHT REARVIEW MIRROR	1		
7	KA204250100	左后视镜	LEFT REARVIEW MIRROR	1		
8	KA003060000	防护杆衬套(ø32)	BUSH, BRUSH GUARD BAR (ø32)	2		
9	KA003070000	防护杆衬套(ø 25)	BUSH, BRUSH GUARD BAR (ø25)	6		
10	GB5787-86	六角法兰螺栓 M8×50	BOLT FLANGE M8×50	6		
11	50199-BCA0-0000-0C	R-垫	R-WASHER	20		
12	GB6187-86	六角法兰自锁螺母 (M8)	LOCK NUT FLANGE (M8)	6		
13	GB5787-86	六角法兰螺栓 M8×55	BOLT FLANGE M8×55	8		
14	GB6187-86	六角法兰自锁螺母 (M10)	LOCK NUT FLANGE (M10)	2		



KINROAD

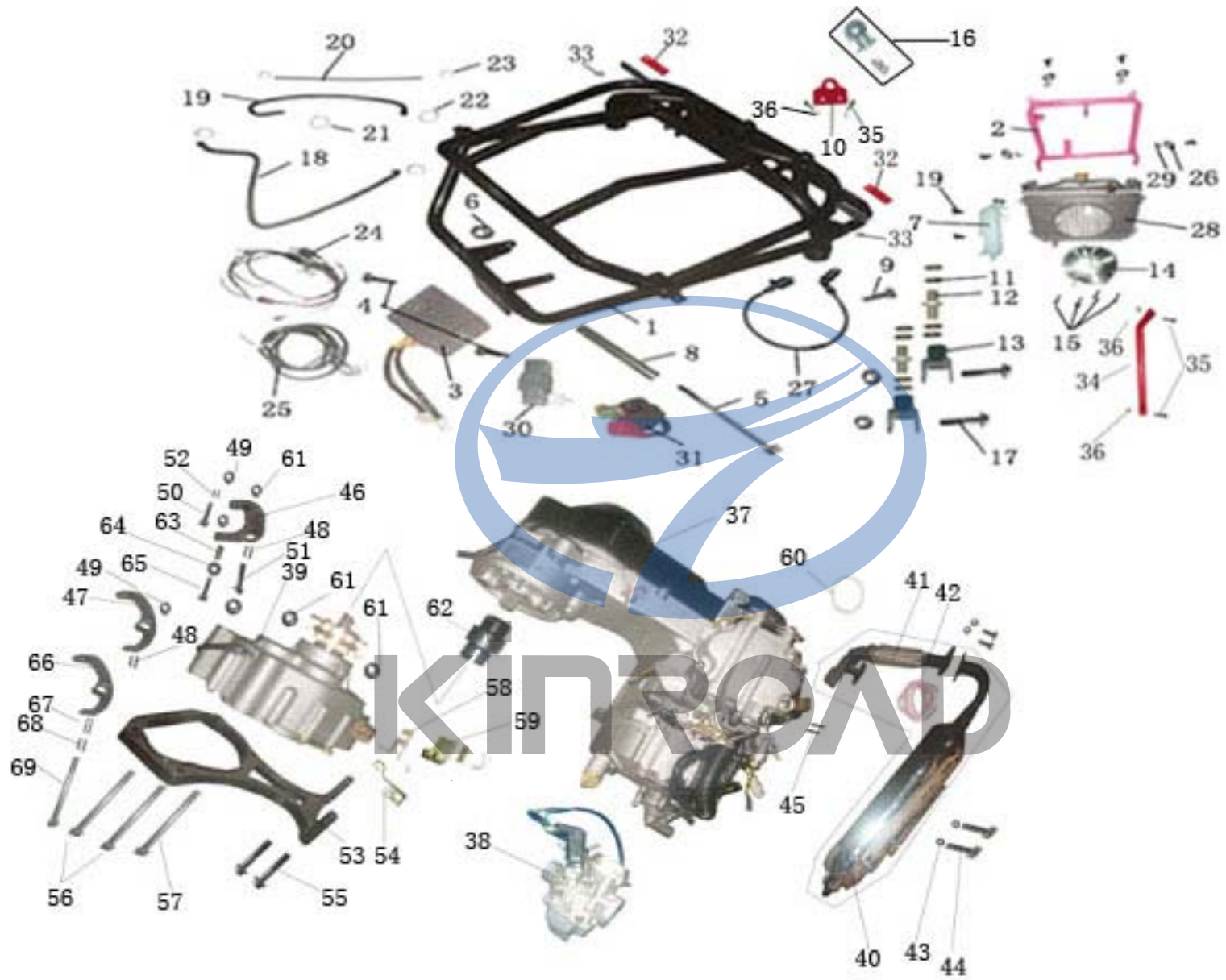

NO.	Part NO.	Description	Description in English	数量Qty	价格Price	备注Remark
1	KB00119001A	后摆臂组件	SWING ARM COMP., RR	1		
2	KB001810030	散热器固定座	FIXING BASE, RADIATOR	1		
3	KB004040000	调压整流器	RECTIFIER COMP, REGULATE	1		
4	GB5787-86	六角法兰螺栓 M6×30	BOLT FLANGE M6×30	2		
5	GB5787-86	发动机轴 M10×1.25×220	SHAFT, HANGER M10×1.25×220	1		
6	GB6187-86	六角法兰自锁螺母 M10×1.25	LOCK NUT FLANGE M10×1.25	1		
7	KB004210000	副水箱	WATER TANK, SUBSIDIARY	1		
8	KB001650080	发动机衬套	ENGINE ASSY COLLAR, INNER	1		
9	GB/T818-85	十字盘头螺钉 M5×20	BOLT M5×20	1		
10	KB2S1400000	拖车挂钩安装支架	TRAILER HATCH	1		
11	GB41-86	调节螺母M20×2	ADJUSTIVE NUT M20×2	8		
12	KB007210000	调节螺杆	ADJUSTIVE SCREW	2		
13	KB007220000	连接座	CONNECTIVE SEAT	2		
14	KB004300000	风扇	FAN	1		
15	GB/T818-85	十字盘头螺钉 M4×16	BOLT FLANGE M4×16	4		
16	KB2S1300000	拖车挂钩	TRAILER HATCH HOOK	1		
17	GB5787-86	六角法兰螺栓 M12×60×1.25	BOLT FLANGE M12×60×1.25	2		
18	KB004250000	出水胶管	RUBBER TUBE, WATER EX	1		
19	KB004260000	回水胶管	RUBBER TUBE, BACKWATER	1		
20	KB004460000	副水箱通水管	WATER TUBE OF WATER TANK, SUBS	1		
21	KB004340000	卡箍29	CIRCLIP 29	2		
22	KB004240000	卡箍24	CIRCLIP 24	2		
23	KB004230000	卡箍13	CIRCLIP 13	2		
24	KB0A4120000-1	主电缆	MAIN WIRE HARNESS	1		
25	KB0A4130000-1	副电缆1	SUB-WIRING HARNESS 1	1		
26	KA003370000	油箱橡胶圈	RUBBER RING	4		
27	KB004090000	高压包	COIL COMP. IGNITION	1		
28	KB004200000	散热器	RADIATOR	1		
29	KB001650090	安装衬套	COLLAR, INNER	4		
30	KB004080000	C. D. I. 点火器	C. D. I. UNIT	1		
31	KB004050000	起动继电器	STARTING RELAY	1		
32	KA204190000	后方反射器	REAR REFLECTOR	2		

33	GB6187-86	六角法兰自锁螺母 M6	LOCK NUT FLANGE M6	8		
34	KF9S1070000	散热器固定座支撑杆	FIXED LINK, RADITOR	1		
35	GB5787-86	六角法兰螺栓 M8×20	BOLT FLANGE M8×20	4		
36	GB6187-86	六角法兰自锁螺母 M8×1.25	LOCK NUT FLANGE M8×1.25	4		
37	KB002010000	发动机	ENGINE ASSY	1		
38	KB002020000	化油器	CARBURETOR ASSY	1		
39	KB005610000	倒档器总成	REVERSE ASSY.	1		
40	KB0A2040000-1	排气消声器	MUFFLER COMP., EX	1		
41	KB0A2042000-1	排气消声器前部	MUFFLER COMP. TORESIDE	1		
42	KB0A2043000	排气消声器密封垫2	GASKET, EX. PIPE2	1		
43	GB6187-86	六角法兰自锁螺母 M10×1.25	LOCK NUT FLANGE M10×1.25	5		
44	GB5787-86	六角法兰螺栓 M10×1.25×50	BOLT FLANGE M10×1.25×50	2		
45	GB6187-86	盖形螺母 M8×35	NUT, MUFFLER JOINT M8×35	2		
46	KB001650038	发动机固定板	FIXED BOARD, ENGINE	1		
47	KB001650039	倒档器固定板1	FIXED BOARD, REVERSE	1		
48	KB001650040	缓冲衬套	RUBBER BUSH, SWING ARM	2		
49	GB6187-86	六角法兰自锁螺母 M10×1.25	LOCK NUT FLANGE M10×1.25	4		
50	GB5787-86	六角法兰螺栓 M10×1.25×50	BOLT FLANGE M10×1.25×50	2		
51	GB5787-86	六角法兰螺栓 M12×1.25×60	BOLT FLANGE M10×1.25×60	2		
52	KB001650095	小衬套Φ16×Φ10.5×10	BUSH Φ16×Φ10.5×10	1		
53	KB001650030	倒档器安装板	BRACKET, REVERSE	1		
54	KB101840030	换档线安装板	MOUNTING BOARD, GEAR SHIFTING	1		
55	GB5787-86	六角法兰螺栓 M8×1.25×40	BOLT FLANGE M10×1.25×40	2		
56	GB5787-86	六角法兰螺栓 M10×1.25×124	BOLT FLANGE M10×1.25×60	2		
57	GB5787-86	六角法兰螺栓 M10×1.25×114	BOLT FLANGE M10×1.25×115	1		
58	KB001850030	换档臂回位扭簧	RETURN SPRING, GEAR SHIFTING	1		
59	KB101830030	换档臂	ARM, GEAR SHIFTING	1		
60	KB002040100	排气消声器密封垫1	GASKET, EX. PIPE 1	1		
61	GB6187-86	六角法兰自锁螺母 M12×1.25	LOCK NUT FLANGE M10×1.25	1		
62	KB005613100	连接套	SPACER, REVERSE	1		
63	KB001650096	铁衬套Φ12.5×Φ10.5×30.5	BUSH Φ12.5×Φ10.5×30.5	1		
64	KB001650097	大平垫	WASHER	1		
65	GB5787-86	六角法兰螺栓 M10×1.25×60	BOLT FLANGE M10×1.25×50	1		
66	KB001650039	倒档器固定板2	FIXED BOARD, REVERSE	1		
67	KB001650098	小衬套Φ16×Φ10.5×10	BUSH Φ16×Φ10.5×10	1		

68	KB001650099	尼龙套	NYLON BUSH	1		
69	GB5787-86	六角法兰螺栓 M10×1.25×15	BOLT FLANGE M10×1.25×150	1		



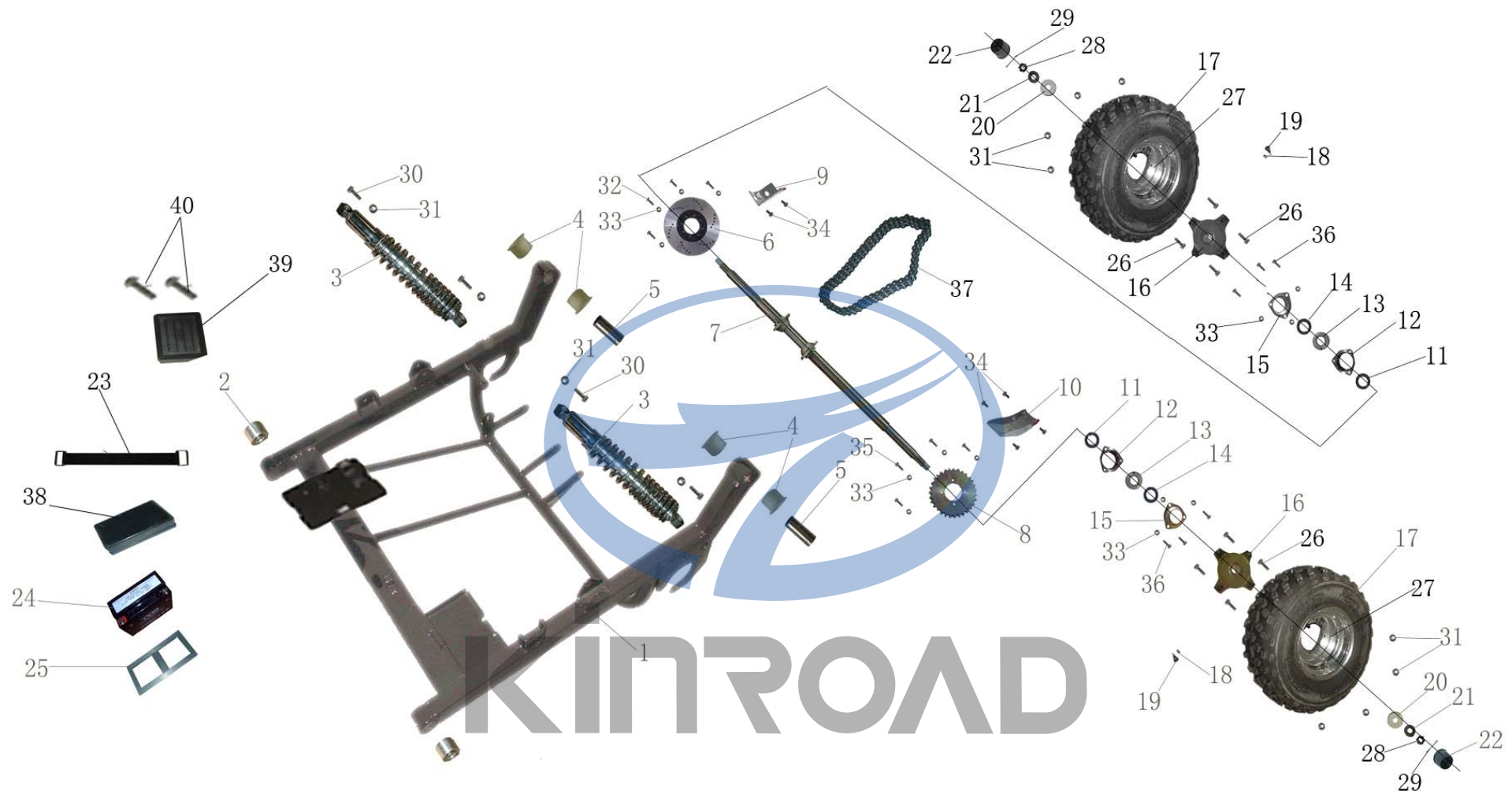

NO.	Part NO.	Description	Description in English	數量Qty	价格Price	备注Remark
1	KA00119001A	后摇架组件	REAR SWING ARM COMP.	1		
2	KA101010100	缓冲套	RUBBER BUSH, SWING ARM	2		
3	KA00632001B	后减震器	ABSORBER ASSY. RR.	2		
4	KA101020000	下悬挂尼龙衬套	BUSH, REAR SWING ARM	4		
5	KA101010400	后下发动机摆臂连接套筒心套	SPACER, CENTER	2		
6	KA105310200-2	后碟刹盘组件	DISC, RR. BRAKE	1		

7	KA005060030	后轮轴	AXLE COMP., RR.	1		
8	KA005220030	后链轮	REAR SPROCKET	1		
9	KA00164001A	碟刹盘罩	COVER DISC, RR. BRAKE	1		
10	KA00163001A	后链轮罩	COVER REAR SPROCKET	1		
11	KA005430000	油封 50×34-7	DUST SEAL 50×34-7	2		
12	KA005070030	后轮轴承座	HOUSING COMP, RR. AXLE BRG	2		
13	KA005530000	轴承 6206 RZ	BEARING 6206 RZ	2		
14	KA005420000	油封28×42-7	DUST SEAL 42×28-7.3	2		
15	KA001570030	后轮轴承座盖	BEARING BASE	2		
16	KA005050030	后轮毂	HUB, RR. AXLE	2		
17	KA005040000	真空胎 22×11-10	TIRE, RR. 22×11-10	2		
18	KA005030200	气门嘴帽	CAP, TIRE INTAKE	2		
19	KA005030100	气门嘴	INTAKE, TIRE	2		
20	KA001580030	后轮帽座	HOLDER, RR. WHEEL CAP	2		
21	94110-17B01-0C	平垫 (ø16)	FLAT WASHER (ø16.5)	2		
22	KA003350000	后轮轴盖	CAP, RR. WHEEL	2		
23	KA001600030	蓄电池绑带	PRESSURE PLATE, BATTERY	1		
24	KA004070000	蓄电池	BATTERY	1		
25	KA003360000	蓄电池垫	CUSHION, BATTERY	1		
26	44901-BCA0-0000-0C	辐板轮安装螺栓 (M10)	BOLT, TIRE (M10)	8		
27	KA005020000	后辐板轮10-8	RIM, REAR	2		
28	GB6178-86	六角开槽螺母M16×1.5	NUT M16×1.5	2		
29	GB/T91-86	开口销3.2×32	PIN3.2×32	2		
30	GB5787-86	六角法兰螺栓 M10×40	BOLT FLANGE M10×40	4		
31	GB6187-86	六角法兰自锁螺母 M10	LOCK NUT FLANGE M10	12		
32	GB5787-86	六角法兰螺栓 M8×25	BOLT FLANGE M8×20	4		
33	GB6187-86	六角法兰自锁螺母 M8	LOCK NUT FLANGE M8	14		
34	GB5787-86	六角法兰螺栓M8×16	BOLT FLANGE M8×16	6		
35	GB5787-86	六角法兰螺栓 M8×35	BOLT FLANGE M8×35	4		
36	GB5787-86	六角法兰螺栓 M8×40	BOLT FLANGE M8×40	6		
37	KA005230000	链条10A	DRIVE CHAIN	2		
38	KA003030000	蓄电池盖	COVER, BATTERY	1		
39	KB003010000	电器盒	WIRING BOX	1		
40	GB818-85	十字盘头螺钉M6×20	BOLT FLANGE M6×20	2		

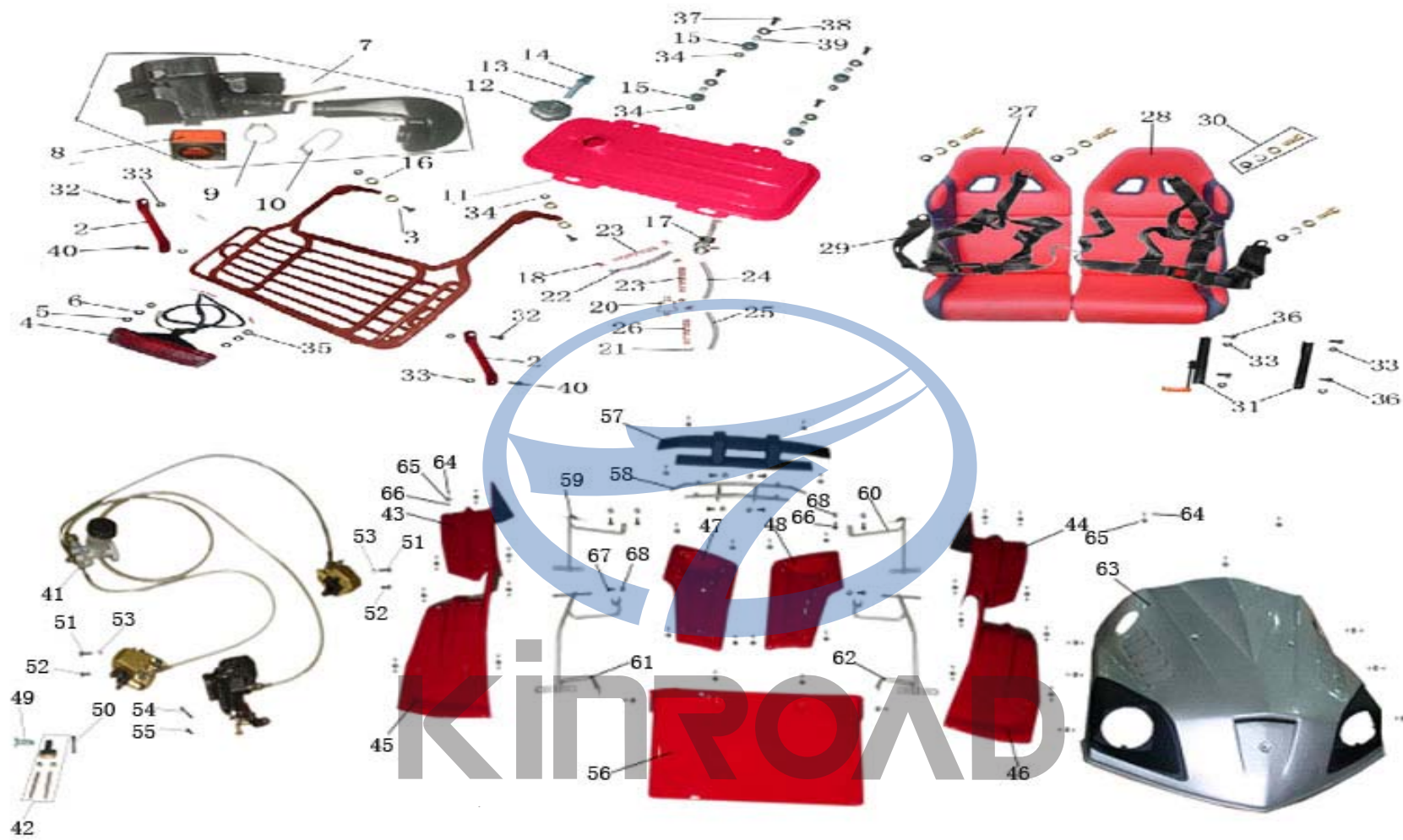

NO.	Part NO.	Description	Description in English	數量Qty	价格Price	备注Remark
1	KB101130000	后储物架组件	CARRIER COMP., REAR	1		
2	KB101140000	后储物架支架	SUPPORTER, CARRIER	2		
3	GB5787-86	六角法兰螺栓 M8×45	BOLT FLANGE M8×45	2		
4	KA004110000	后尾灯	TAIL LAMP ASSY.	1		
5	KA003100000	后尾灯绝缘垫A	INSULATING PAD A, TAIL LIGHT	2		
6	KA003110000	后尾灯绝缘垫B	INSULATING PAD B, TAIL LIGHT	2		
7	KB002030000	空滤器组件	CASE COMP., AIR CLEANER	1		
8	KB002030100	海绵	ELEMENT, AIR CLEANER	1		
9	KB002030200	空滤器接管卡箍1	CALIPER1, AIR CLEANER	1		
10	KB002030300	空滤器接管卡箍2	CALIPER1, AIR CLEANER	1		
11	KA202060000	油箱	TANK, COMP. FUEL	1		
12	KA002060100	油箱盖	CAP, COMP. FUEL TANK	1		
13	KA003220000	导流管	TUBE COMP. VACUUM	1		
14	KA002070000	止回阀	CHECK VALVE	1		
15	KA003370000	油箱橡胶圈	RUBBER RING	4		
16	50199-BCA0-0000-0C	R垫	R WASHER	4		
17	KA002080000	油箱开关	COCK, FUEL ASSY.	1		
18	KA001870050	气管卡簧	CIRCLIP, AIR PIPE	2		
19	GB5787-86	六角法兰螺栓 M8×55	BOLT FLANGE M8×55	2		
20	KA002090000	过滤器	FILTER	1		
21	KA001860050	油管卡簧	CIRCLIP, FUEL TUBE	4		
22	KA003230000	气管	TUBE COMP. VACUUM	1		
23	KA001850050	保护网I	TUBE SPRING I	2		
24	KA003210100	油管I	TUBE COMP. FUEL. I	1		
25	KA003210200	油管II	TUBE COMP. FUEL. II	1		
26	KA001830050	保护网II	TUBE SPRING II	1		
27	KA107010100-1	右座垫	RIGHT SEAT ASSY	1		
28	KA107010200-1	左座垫	LEFT SEAT ASSY	1		
29	KA107080000-1	五点式保险带	BELT. SAFETY	1		
30	KA107080100-1	保险带附件	BOLT BELT. SAFETY	1		
31	KA20705001A	滑轨	RAIL SET. SEAT	1		
32	GB5787-86	六角法兰螺栓 M8×25	BOLT FLANGE M8×25	2		
33	GB6187-86	六角法兰自锁螺母 M8	LOCK NUT FLANGE M8	12		
34	GB6187-86	六角法兰自锁螺母 M8	LOCK NUT FLANGE M8	4		

35	GB6187-86	六角自锁螺母 (M5)	NUT FLANGE M5	2		
36	GB5787-86	六角法兰螺栓 M8×16	BOLT FLANGE M8×16	8		
37	GB5787-86	六角法兰螺栓 M6×30	BOLT FLANGE M6×30	4		
38	GB/T95-87	平垫 φ6	FLAT WASHER ø6	4		
39	KB001650086	安装衬套	COLLAR, INNER	4		
40	GB5787-86	六角法兰螺栓 M8×25	BOLT FLANGE M8×25	4		
41	KA105310000-1	制动泵总成	FOUR-CALIPER BRAKE ASSY	1		
42	KA105310100-2	主压杆	PUSH ROD, MASTER	1		
43	KA003170100	左前挡泥板	FRONT FENDER, L	1		
44	KA003170200	右前挡泥板	FRONT FENDER, R	1		
45	KA003180100	左后挡泥板	REAR FENDER, L	1		
46	KA003180200	右后挡泥板	REAR FENDER, R	1		
47	KA003190100	左侧护板	COVER ,L	1		
48	KA003190200	右侧护板	COVER ,R	1		
49	GB/T882-86	B型销轴(带销孔ø2)6×30	PIN 6×30	1		
50	GB/T91-86	开口销 1.6×16	PIN 1.6×16	1		
51	GB5787-86	六角法兰螺栓 M8×35	BOLT FLANGE M8×35	2		
52	GB5787-86	六角法兰螺栓 M8×25	BOLT FLANGE M8×25	10		
53	GB/T93-87	弹垫8	WASHER ,SPRTNG ø8	2		
54	GB5787-86	六角法兰螺栓 M8×96	BOLT FLANGE M8×96	1		
55	GB5787-86	六角法兰螺栓 M8×12	BOLT FLANGE M8×12	1		
56	KA003200000	后挡雨板	COVER ,REAR	1		
57	KA003210000	前保险杠	FRONT BRUSH GUARD BAR	1		
58	KA001940030	前保险杠支架	BRACKEY, FRONT BRUSH GUARD BAR	1		
59	KA003180100	前左挡泥板支架	BRACKEY, FRONT FENDER, L	1		
60	KA003180200	前右挡泥板支架	BRACKEY, FRONT FENDER, R	1		
61	KA00137001A	左后挡泥板支架	BRACKEY, REAR FENDER, L	1		
62	KA00138001A	右后挡泥板支架	BRACKEY, REAR FENDER, R	1		
63	KA003160000	前面罩	COVER ,FRONT	1		
64	GB5787-86	十字盘头螺钉M6×16	BOLT M6×16	41		
65	KM003440000	橡胶垫圈 Φ20×2	RUBBER WASHER (ø6)	41		
66	GB6187-86	六角法兰自锁螺母 (M6)	LOCK NUT FLANGE (M6)	22		
67	GB5787-86	六角法兰螺栓 M8×30	BOLT FLANGE M8×30	2		
68	GB6187-86	六角法兰自锁螺母 (M8)	LOCK NUT FLANGE (M8)	10		